

**Technical performance of the tension clamp Skl 19:**

- :: Tension clamp Skl 19 with a dynamic long-term durability of 1.4 mm oscillation range
- :: Clamping force of Skl 19 is defined for the contact position of the medium loop with the rip of the base plate
- :: The design of the tension clamp allows the use in narrow positions

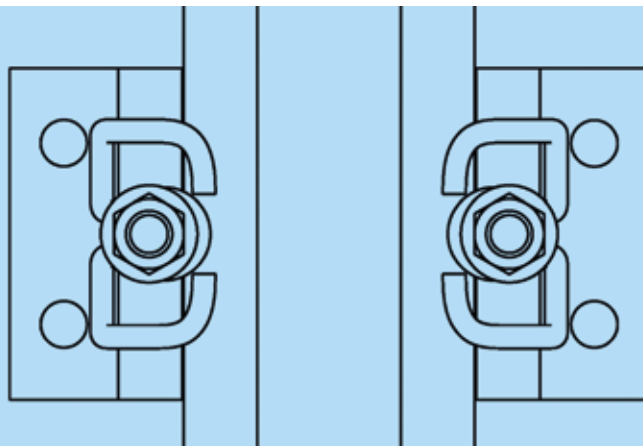

The rail fastening system can be used for applications on concrete, wooden and steel sleeper.  
The main applications are in special parts of turnouts (e.g. narrow spaces) and in transition regions before and after the turnouts.

Assembling advice after rail positioning:  
The medium loop of the tension clamp Skl 19 is fixed with a t-bolt and a nut on the rip of the base plate.

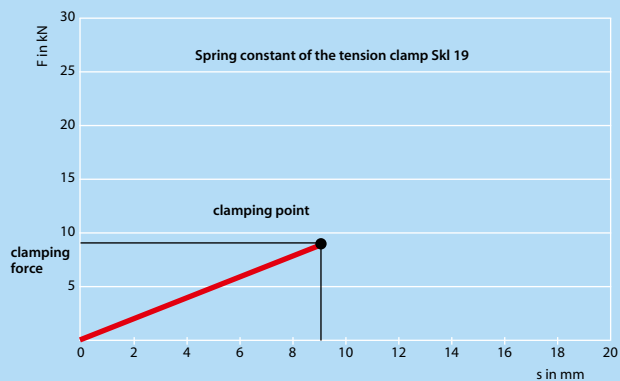
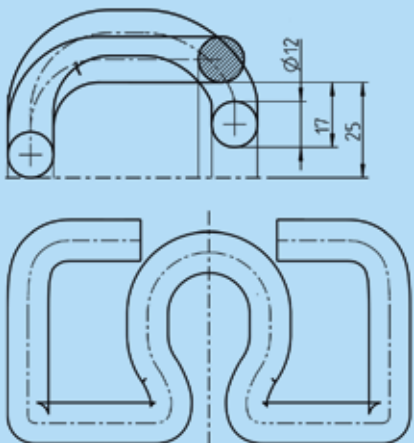

Unconnected delivery of the tension clamps



**SCHWIHAG AG**  
Track and Switch Technology  
Lebernstrasse 3, CH-8274 Tägerwilten  
Phone +41(0)71 666 88 00 Fax +41(0)71 666 88 01  
info@schwihag.com www.schwihag.com

..... INNOVATIVE TRACK AND SWITCH TECHNOLOGY .....



**RAIL FASTENING SYSTEM AS SINGLE SUPPORT  
POINT FOR SLAB TRACK ON RESILIENT  
SUPPORTED BASE PLATE WITH TENSION  
CLAMP SKL 19**